

# EQUINOX

## UFO

### User Manual



Order code: EQLED463

### WARNING

## FOR YOUR OWN SAFETY, PLEASE READ THIS USER MANUAL CAREFULLY BEFORE YOUR INITIAL START-UP!

- Before your initial start-up, please make sure that there is no damage caused during transportation.
- Should there be any damage, consult your dealer and do not use the equipment.
- To maintain the equipment in good working condition and to ensure safe operation, it is necessary for the user to follow the safety instructions and warning notes written in this manual.
- Please note that damages caused by user modifications to this equipment are not subject to warranty.



### IMPORTANT:

**The manufacturer will not accept liability for any resulting damages caused by the non-observance of this manual or any unauthorised modification to the equipment.**

- Never let the power cable come into contact with other cables. Handle the power cable and all mains voltage connections with particular caution!
- Never remove warning or informative labels from the unit.
- Do not open the equipment and do not modify the unit.
- Do not connect this equipment to a dimmer pack.
- Do not switch the equipment on and off in short intervals, as this will reduce the system's life.
- Only use the equipment indoors.
- Do not expose to flammable sources, liquids or gases.
- Always disconnect the power from the mains when equipment is not in use or before cleaning! Only handle the power-cable by the plug. Never pull out the plug by pulling the power-cable.
- Make sure that the available mains supply voltage is between 100~240V AC, 50/60Hz.
- Make sure that the power cable is never crimped or damaged. Check the equipment and the power cable periodically.
- If the equipment is dropped or damaged, disconnect the mains power supply immediately and have a qualified engineer inspect the equipment before operating again.
- If the equipment has been exposed to drastic temperature fluctuation (e.g. after transportation), do not connect power or switch it on immediately. The arising condensation might damage the equipment. Leave the equipment switched off until it has reached room temperature.
- If your product fails to function correctly, stop use immediately. Pack the unit securely (preferably in the original packing material), and return it to your Pro Light dealer for service.
- Only use fuses of same type and rating.
- Repairs, servicing and power connection must only be carried out by a qualified technician. **THIS UNIT CONTAINS NO USER SERVICEABLE PARTS.**
- This lighting fixture is for professional use only - it is not designed for or suitable for household use. The product must be installed by a qualified technician in accordance with local territory regulations. The safety of the installation is the responsibility of the installer. The fixture presents risks of severe injury or death due to fire hazards, electric shock and falls.
- Warning! Risk Group 2 LED product according to EN 62471. Do not view the light output with optical instruments or any device that may concentrate the beam.
- **WARRANTY:** One year from date of purchase.

### OPERATING DETERMINATIONS

If this equipment is operated in any other way, than those described in this manual, the product may suffer damage and the warranty becomes void. Incorrect operation may lead to danger e.g: short-circuit, burns and electric shocks etc.

Do not endanger your own safety and the safety of others!

Incorrect installation or use can cause serious damage to people and/or property.

**Please note:** These fixtures are intended for stage lighting and entertainment applications only, and are not intended for extended periods of use, including but not limited to house-light, industrial or architectural applications and should only be operated with short duty cycles.

### UFO

The Equinox UFO is a multi-beam moving head creating unique and dynamic effects. Its narrow, razor-sharp beams of RGBW light create rotating aerial effects that rise, fall and hover. The sleek single arm design is both robust, compact and light weight. Built-in auto and sound-activated light shows are pre-programmed whilst multiple fixtures can be linked in primary and secondary modes. DMX is also on-board for endless control options.

- 6 x 40W quad-colour LEDs (RGBW)
- Beam angle: 2°
- Refresh Rate: 20kHz
- DMX channels: 16
- Auto, sound active, manual and primary/secondary modes
- 16-Bit pan/tilt positioning
- Base pan: 540°, Tilt: 270°, Head pan: 360° continuous
- 0–100% dimming
- 4 dimming curves in both LED and halogen profiles: Linear, square law, inverse square law and S-curve
- Variable strobe
- Quick release omega clamp included
- 4 button menu with 2" LCD display
- PowerTwist input/output
- 3-Pin XLR input/output
- Fan cooled



Specifications	UFO
Power consumption	226W
Power supply	100~240V, 50/60Hz
Fuse	F5A 250V
Dimensions	335 x 295 x 208mm
Weight	6.2kg
Order code	EQLED463

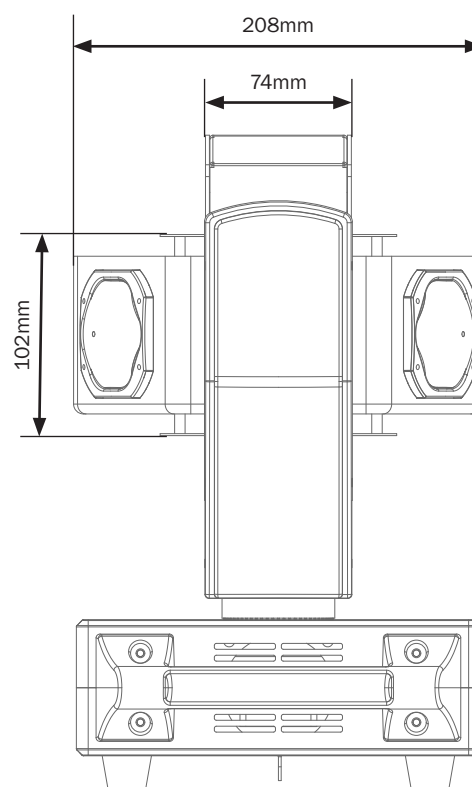
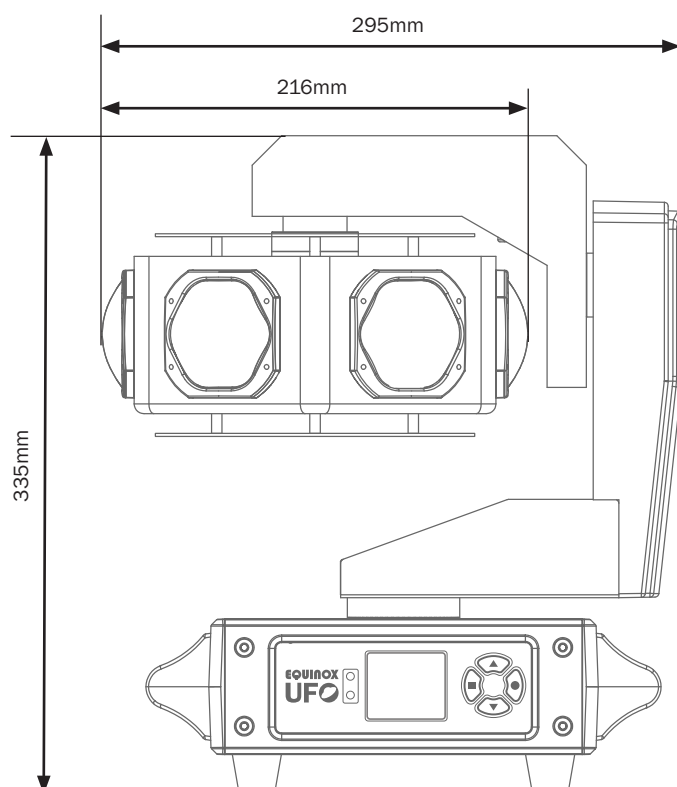

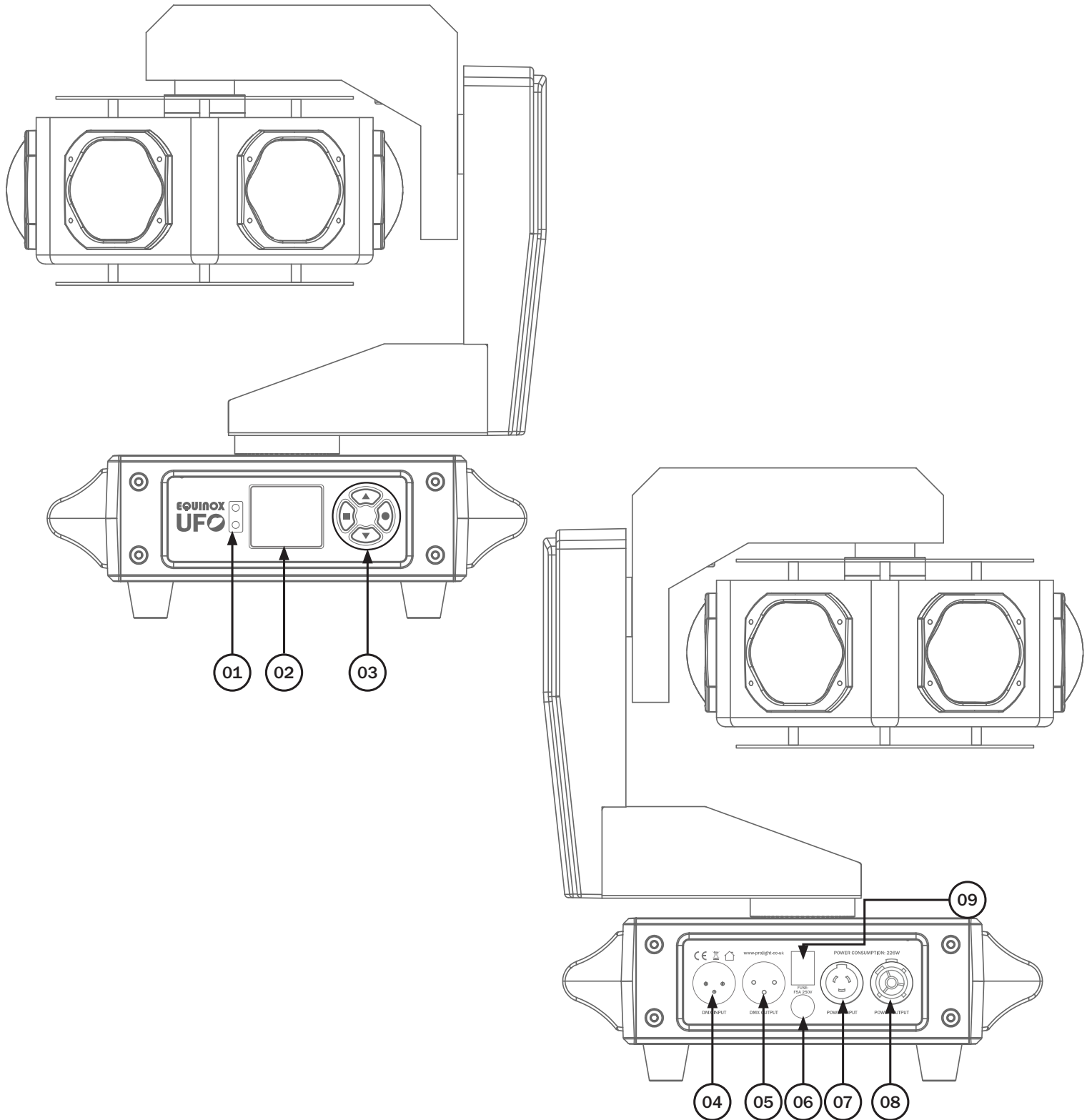

01 -  
02 - LCD display  
03 - Function buttons

04 - 3-Pin DMX input  
05 - 3-Pin DMX output  
06 - Fuse F5A 250V

07 - PowerTwist input  
08 - PowerTwist output  
09 - Switch On/Off

In the box:  
**1 x fixture with  
hanging bracket,  
& 1 x power cable**

Before installing the fixture, the supporting structure (ie. truss) must be able to hold a minimum of 10 times the fixtures weight without any deformation (eg. 15kg - 150kg point load). The fixture must be secured with a secondary safety attachment when being installed (ie. an appropriate safety cable). Never stand directly below the fixture when mounting, removing, and/or servicing.

Overhead installation requires experience and qualifications to calculate working load limits, the material being used at the installation area and periodic safety inspections of the fixture and installation material. If you do not have the relevant experience and/or qualifications please do not attempt the installation yourself. The installation should be checked annually by a qualified person.

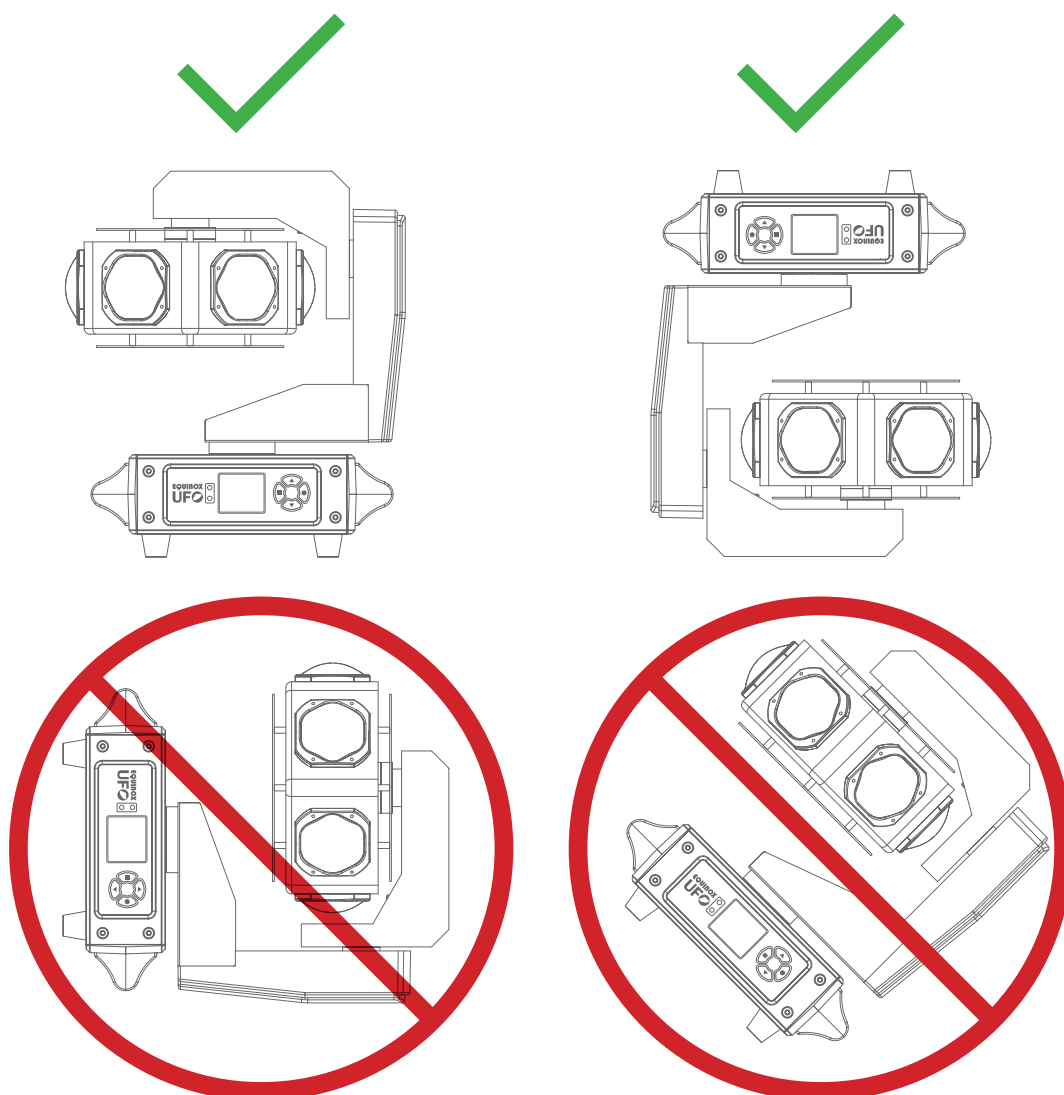

The Equinox UFO can be operated where the base of the fixture is horizontally orientated, this includes standing the fixture upright on a flat, level surface or hanging the fixture upside down. Do NOT install the fixture in a sideways position or in a position where the base of the fixture is orientated vertically or at an angle. Always use a safety wire as an extra safety precaution to prevent damage/injury in the event a clamp fails (see the next page for clamp installation). Never use the carry handles for secondary attachments.

### Installation:

1. Fasten each clamp to the omega clamp with a bolt and lock nut through the hole in the omega clamp.
2. Align and insert the omega clamp quick-lock fasteners with the respective holes on the bottom of the unit.
3. Tighten both locking fasteners clockwise on an omega clamp ensuring it's fully secure.
4. Mount the fixture onto your truss system via the clamp and tighten to ensure secure.
5. Pull the safety cable through the safety eye located on the metal base plate on the underside of the fixture and around the truss.

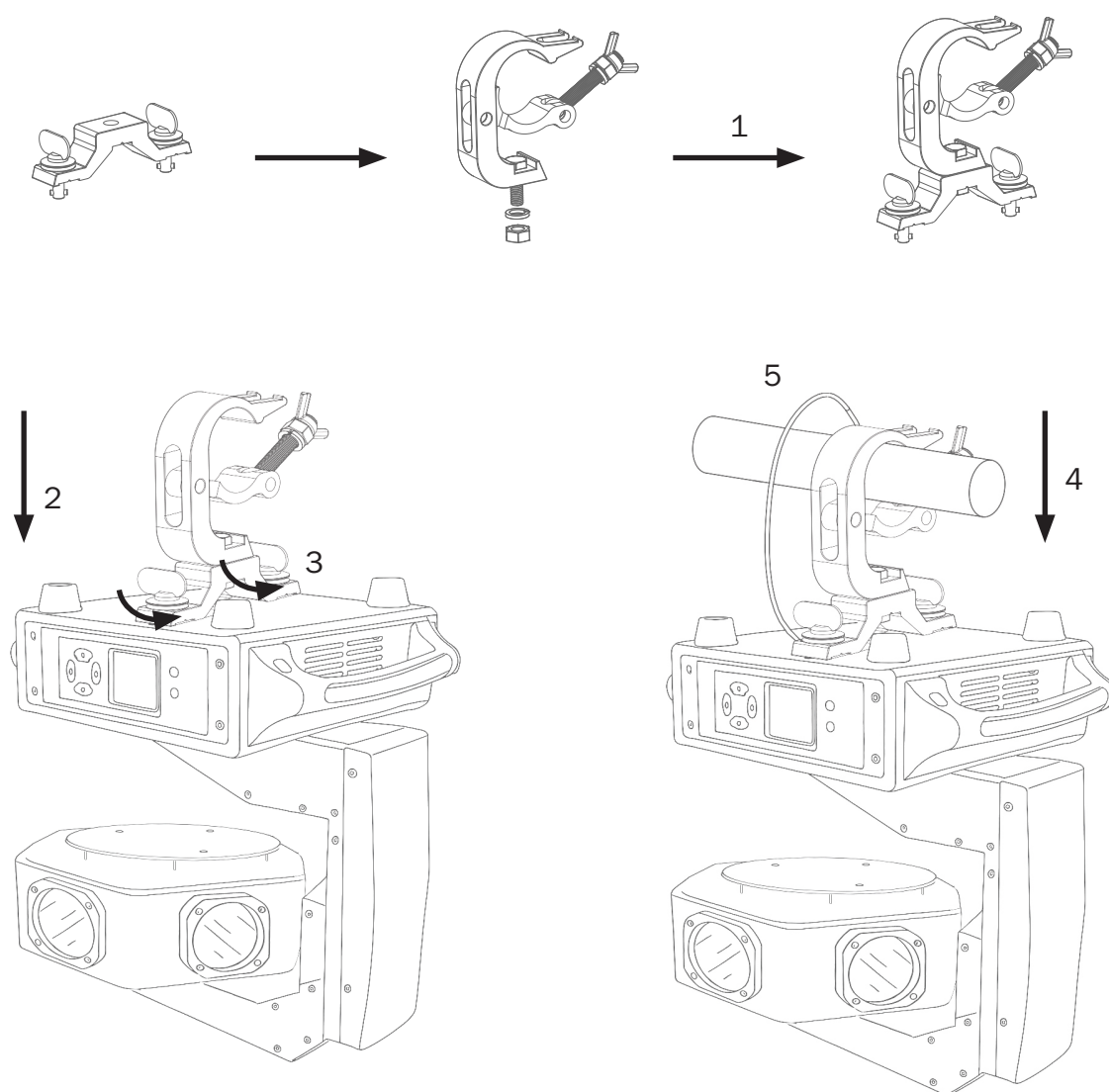

### Control Panel Menu:

The LCD control panel situated on the front of the fixture allows the user to access the menu system to adjust the fixtures settings.

When the unit has been powered on the display will show “**Software update...**”, “**Welcome**” whilst the unit performs its motor reset. The fixture will then return to its home screen.

Using the “**UP**” and “**DOWN**” buttons you can then navigate between the different options in the main menu. Pressing the “**ENTER**” button on one of these options allows you to access the sub menu where you can use the “**UP**” and “**DOWN**” buttons to select option/value required. Once the option/value has been selected press the “**ENTER**” button once more to confirm the setting.

To exit out of any of the above options, press the “**MENU**” button.

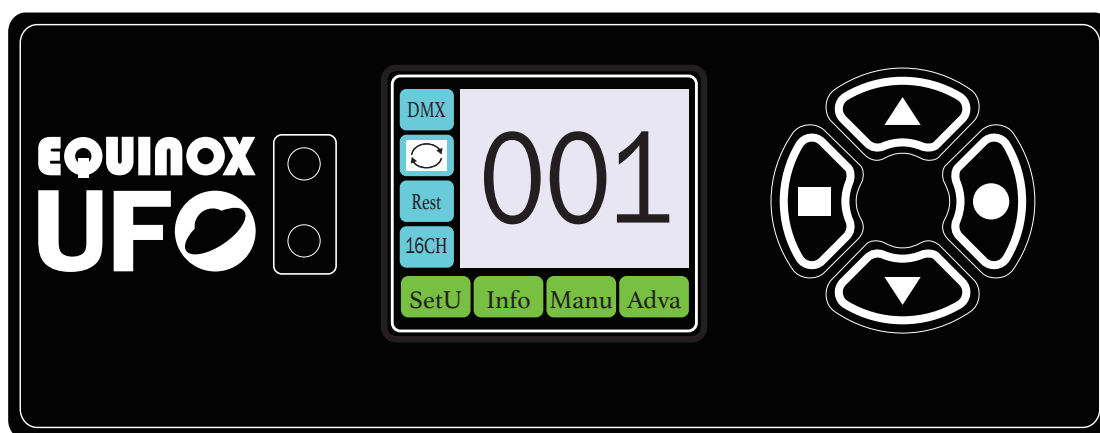



### DMX:

To setup and control your light by an external DMX controller:

Press “▼” until “SetU” is highlighted on the display. Press “●” and use “▼” button to highlight “DMX Address”. Press “●” and use the “▲” and “▼” to set the required DMX address.

Press the “ENTER” button to confirm the settings.

Now connect your DMX controller to the fixtures DMX input via a 3-Pin DMX cable.

### Auto/sound modes:

To use one of the fixtures built-in programs:

Press “▼” until “DMX” is highlighted on the display. Press “●” and “DMX” will change to “Auto”. The unit will now run in it’s auto mode.

If you would like the fixture to change to the beat of the music:

Repeat the steps above, however once the display changes from “DMX” to “Auto”, press “●” once more and “Soud” will be displayed

To adjust the sound sensitivity, press “▼” until “SetU” is highlighted on the display. Press “●” and use “▼” button to highlight “Sensitivity”. Press “●” and use the “▲” and “▼” to set the required sound sensitivity between 0-100. Press the “●” button to confirm the setting.

(0 = sound off, 1 = low, 100 = high)

### Linking multiple fixtures (primary/secondary):

To link multiple fixtures together:

Connect the fixtures together with a 3-Pin DMX cable.

On the primary unit, press “▼” until “DMX” is highlighted on the display. Press “●” and “DMX” will change to “Auto”. The unit will now run in it’s auto mode. If sound mode is required press “●” once more.

On the secondary unit, ensure “DMX” is displayed on the top left of the display.

The unit will now run in sequence with the primary unit.

Ensure all units are set to DMX Address 001.



Main Menu	Options/Values (Default Settings in BOLD)		Description
DMX address	<b>001</b> -512 - the large font displays the curreny DMX address		DMX address setting
Mode	DMX		Operation mode setting
	Auto		
	Sound		
	Manu		
Reverse (↺)	Display invert		Display invert setting
Rest	Factory reset		Default factory settings
16CH	16 DMX Channels		DMX channel setting
SetU	Run Mode	DMX/Auto/Sound/Manu	Run mode setting
	DMX Address	001-512	DMX address setting
	Channel Mode	16CH	DMX channel setting
	Sensitivity	000-100	Sound sensitivity setting
	Dimmer Curve	Linear/S-Cur/InSqu/Square	Dimmer curve setting
	Dimmer Speed	Fast/Smooth	Dimmer speed setting
	Invert X	Off/On	Pan invert setting
	Invert Y	Off/On	Tilt invert setting
	Exchange X/Y	Off/On	Pan/Tilt channel invert
	No DMX Signal	Keep/Clear	DMX fail setting
	Display Reverse	Yes/No	Display invert setting
	Display Backlight	Yes/No	Display backlight setting
	Motor Reset	OK/Back	Motor reset
	Load Default	OK/Back	Default factory settings
Info	Software Version	Vx.x	System information
	Total Hour	xxx	
	Current Hour	xxxxx	
	Total LED Hour	xxxxx	
	Current LED Hour	xxxxx	
	Fixture Temperature	xxx °C	
	DMX Monitor		
	System Errors		
Manu	Pan	000-255	Manual control
	Tilt	000-255	
	Pan/Tilt speed	000-255	
	Rotate	000-255	
	Dimmer	000-255	
	Strobe	000-255	
	Red	000-255	
	Green	000-255	
	Blue	000-255	
	White	000-255	
Adva	Only for use by qualified service technician		

### 16 channel mode:

Channel	Value	Function
CH1	000-255	Pan adjustment 0-540°
CH2	000-255	Pan fine adjustment
CH3	000-255	Tilt adjustment 0-270°
CH4	000-255	Tilt fine adjustment
CH5	000-255	Pan/tilt speed (fast-slow)
Head Pan		
CH6	000-127	Rotation index 0-360°
	128-191	Rotation clockwise (fast-slow)
	192-255	Rotation anti-clockwise (slow-fast)
CH7	000-255	Master dimmer (0-100%)
Strobe		
CH8	000-009	No function
	010-255	Strobe (slow-fast)
CH9	000-255	Red dimmer (0-100%)
CH10	000-255	Green dimmer (0-100%)
CH11	000-255	Blue dimmer (0-100%)
CH12	000-255	White dimmer (0-100%)
Programs / macros		
CH13	000-005	No function
	006-010	Colour fade
	011-020	Colour fade in/out
	021-030	Colour change
	031-240	Colour macros
	241-255	No function
CH14	000-255	Program / macro speed (slow-fast) - when Channel 13 is in use
		Sound sensitivity (low-high) - when Channel 15 is between 128-255
Auto / sound modes		
CH15	000-015	No function
	016-127	Auto
	128-255	Sound (use channel 14 between 001-255 to activate)
CH16	000-249	No function
	250-255	Motor reset (hold for 5s)

### Setting the DMX address:

The DMX mode enables the use of a universal DMX controller. Each fixture requires a “start address” from 1- 512. A fixture requiring one or more channels for control begins to read the data on the channel indicated by the start address. For example, a fixture that occupies or uses 7 channels of DMX and was addressed to start on DMX channel 100, would read data from channels: 100, 101, 102, 103, 104, 105 and 106. Choose a start address so that the channels used do not overlap. E.g. the next unit in the chain starts at 107.

### DMX 512:

DMX (Digital Multiplex) is a universal protocol used as a form of communication between intelligent fixtures and controllers. A DMX controller sends DMX data instructions from the controller to the fixture. DMX data is sent as serial data that travels from fixture to fixture via the DATA “IN” and DATA “OUT” XLR terminals located on all DMX fixtures (most controllers only have a data “out” terminal).

### DMX linking:

DMX is a language allowing all makes and models of different manufacturers to be linked together and operate from a single controller, as long as all fixtures and the controller are DMX compliant. To ensure proper DMX data transmission, when using several DMX fixtures try to use the shortest cable path possible. The order in which fixtures are connected in a DMX line does not influence the DMX addressing. For example; a fixture assigned to a DMX address of 1 may be placed anywhere in a DMX line, at the beginning, at the end, or anywhere in the middle. When a fixture is assigned a DMX address of 1, the DMX controller knows to send DATA assigned to address 1 to that unit, no matter where it is located in the DMX chain.

### DATA cable (DMX cable) requirements (for DMX operation):

This fixture can be controlled via DMX-512 protocol. The DMX address is set on the back of the unit. Your unit requires either a standard 3-pin XLR connector for data input/output, see image below.



Further DMX cables can be purchased from all good sound and lighting suppliers or Prolight Concepts dealers.  
Please quote: 3-Pin: **CABL10 – 2m** **CABL11 – 5m** **CABL12 – 10m**

Also remember that DMX cable must be daisy chained and cannot be split.

### Notice:

Be sure to follow the diagrams below when making your own cables. Do not connect the cables shield conductor to the ground lug or allow the shield conductor to come in contact with the XLRs outer casing. Grounding the shield could cause a short circuit and erratic behaviour.

Pin Configuration	
3-Pin	5-Pin
	Pin 1 - Ground
	Pin 2 - Negative
	Pin 3 - Positive
-	Pin 4 - N/C
-	Pin 5 - N/C

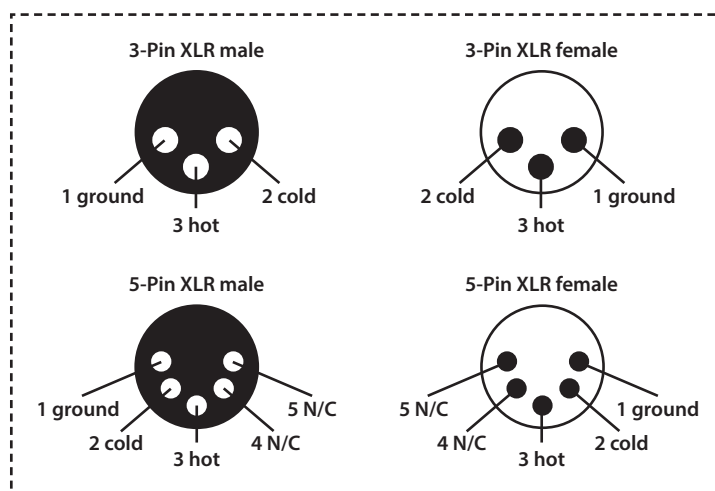
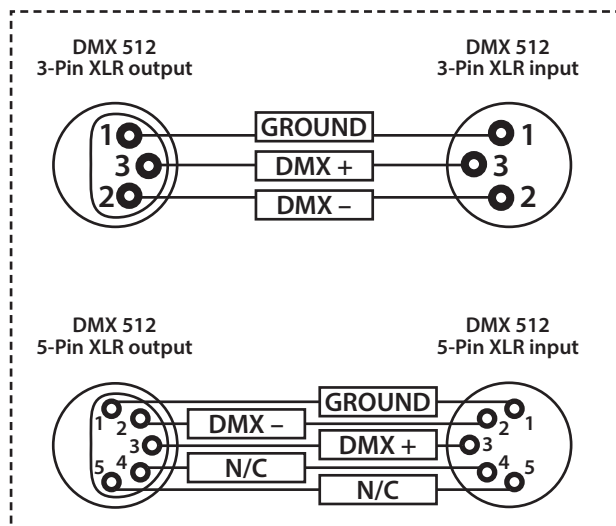

### Line termination:

When longer runs of cable are used, you may need to use a terminator on the last unit to avoid erratic behaviour.

Using a cable terminator will decrease the possibilities of erratic behaviour.

(3-pin - Order ref: CABL90,

5-pin - Order ref: CABL89)

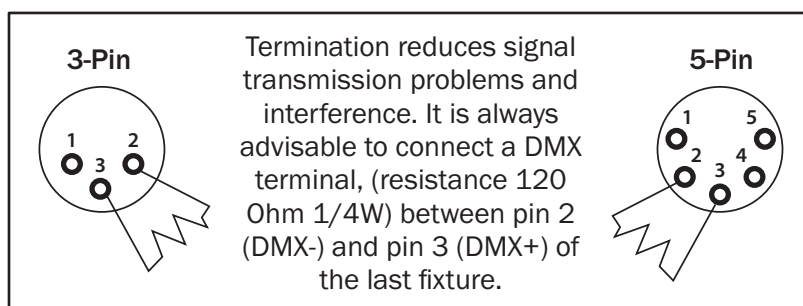

### 5-pin XLR DMX connectors:

Some manufacturers use 5-pin XLR connectors for data transmission in place of 3-pin. 5-pin XLR fixtures may be implemented in a 3-pin XLR DMX line. When inserting standard 5-pin XLR connectors in to a 3-pin line a cable adaptor must be used. The diagram below details the correct cable conversion.

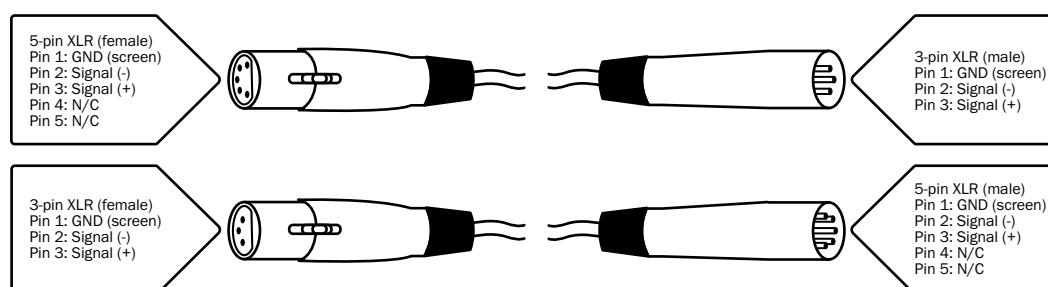

### Power linking:

This fixture provides power linking via the power output on the rear allowing multiple units to be connected together. The maximum number of fixtures that can be connected via a 13A mains input is 6 fixtures @ 240V or 3 fixtures @ 120V (including the first fixture). After the maximum number of fixtures are connected a new power run will need to be started.

Please note: Caution should be used when power linking other fixtures to the UFO as the power consumption of other fixtures will vary. Fixtures fitted with lamps often require 2/3 times more current on startup, these may require their own power source.

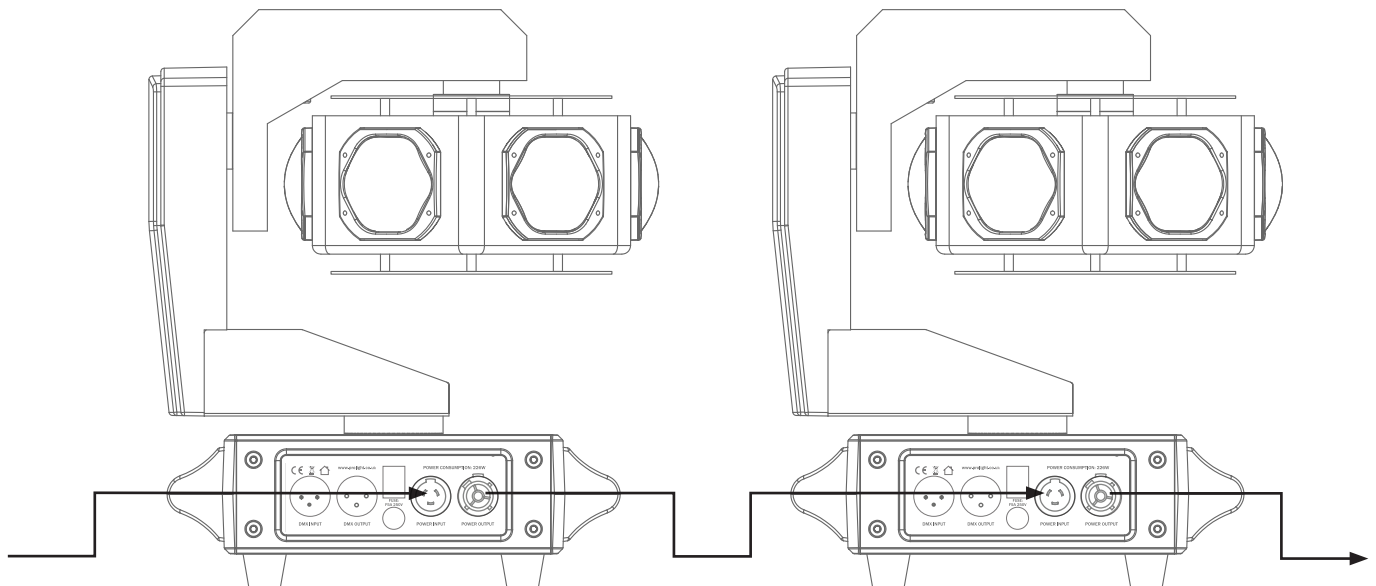



### ***Correct Disposal of this Product (Waste Electrical & Electronic Equipment)***

**(Applicable in the European Union and other European countries  
with separate collection systems)**

This marking shown on the product or its literature, indicates that it should not be disposed with other household wastes at the end of its working life. To prevent possible harm to the environment or human health from uncontrolled waste disposal, please separate this from other types of wastes and recycle it responsibly to promote the sustainable reuse of material resources.

Household users should contact either the retailer where they purchased this product, or their local government office, for details of where and how they can take this item for environmentally safe recycling.

Business users should contact their supplier and check the terms and conditions of the purchase contract. This product should not be mixed with other commercial wastes for disposal.

This notice does not imply a requirement for the product to be returned to the manufacturer or supplier, disposal should be carried out via appropriate authorised recycling facilities in accordance with local regulations.

